

Disclaimer: Drawings produced by DANOSA UK should be considered non-scalable and for illustrative purposes only. Issued design principals form instructions for the installation of DANOSA UK materials only and should be considered as part of an overall design rather than in isolation. Product 'Technical Datasheets' are available for all DANOSA UK products and should be consulted in conjunction with all issued DANOSA UK installation instructions. Drawings are subject to copyright and should not be reproduced without permission.

Drawing Notes:

All substrates should be primed or prepared in accordance with the project specification. Structural substrates shown in this drawing are for illustrative purposes only.

Note A:
Lightning cable clips should be installed at no greater than 1000mm centres, unless otherwise specified by the provided of the lightning protection services.

Note B:
Where a full bond to the substrate is required, or where ESTERDAN 30 P ELAST SEMIADHESVIO is used as the underlay, GLASDAN 800 PERFORADO does not form part of the system.

DANOSA Capsheet
(as specification)

DANOSA Underlay
(as specification)

GLASDAN 800 PERFORADO
(see Note B)

Insulation
(as specification)

Air and Vapour Control Layer
(as specification)

DANOSA SBS Lightning Cable Clip
(see Note A)

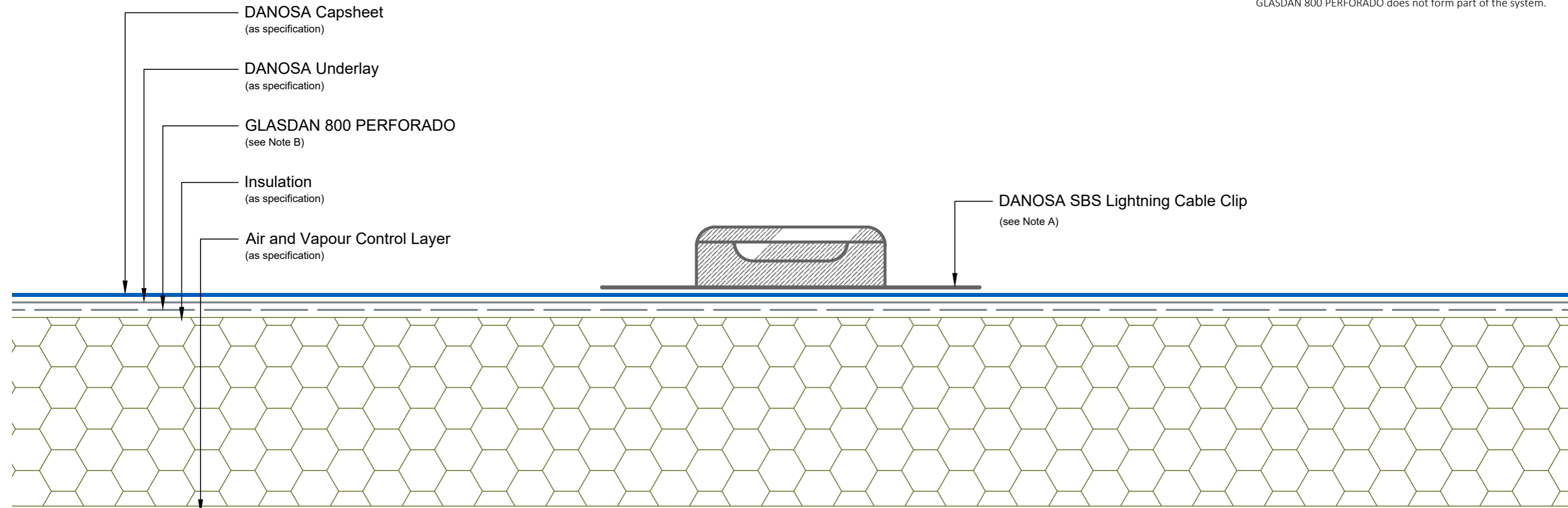

Drawing Number: DUK-B-(G)-340W	Revision: 01
Date Drawn: February 2019	Author: SL

Drawing Title:
Lightning Conductor Clip
Reinforced Bitumen Membranes - Warm Roof



Building together

DANOSA UK Limited

Tel: 0845 074 0553 | www.danosa.co.uk | uktechnical@danosa.com