

Disclaimer: Drawings produced by DANOSA UK should be considered non-scalable and for illustrative purposes only. Issued design principals form instructions for the installation of DANOSA UK materials only and should be considered as part of an overall design rather than in isolation. Product 'Technical Datasheets' are available for all DANOSA UK products and should be consulted in conjunction with all issued DANOSA UK installation instructions. Drawings are subject to copyright and should not be reproduced without permission.

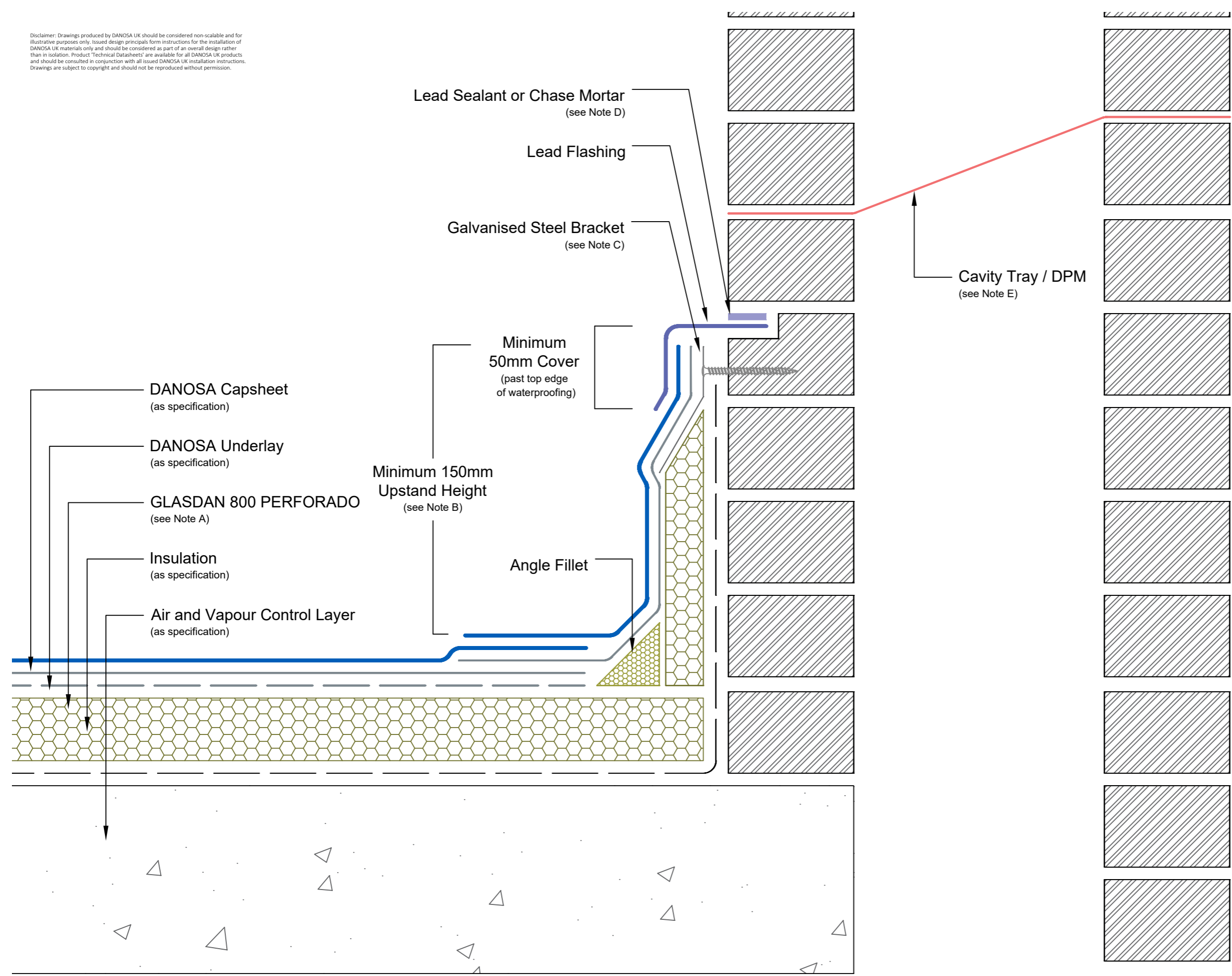

Drawing Notes:

All substrates should be primed or prepared in accordance with the project specification. Structural substrates shown in this drawing are for illustrative purposes only.

All reinforced bitumen membrane side overlaps should be a minimum of 80mm and head laps a minimum of 100mm.

Note A:
Where a full bond to the substrate is required, or where ESTERDAN 30 P ELAST SEMIADHESVIO is used as the underlay, GLASDAN 800 PERFORADO does not form part of the system.

Note B:
Minimum upstand height is measured from the finished surface of the roof finishes to the first mechanical penetration of the waterproofing or otherwise vulnerable junction. When specifying any finishes, such as paving slabs, stone ballast or a living roof, the measurement is made from the top surface of the finishes, not from the waterproofing level.

Note C:
The chamfered edge of the insulation must be protected / supported. When 50mm insulation is utilised, an angle fillet is an acceptable alternative method.

Note D:
Sealants are considered maintenance items and should be checked and replaced regularly as part of annual roof maintenance procedures.

Note E:
The cavity tray / DPM must discharge over the top of any lead counterflashing,

Drawing Number: DUK-B-(G)-320W	Revision: 01
Date Drawn: February 2019	Author: SL

Drawing Title:
Abutment <250mm High with Lead Counterflashing
Reinforced Bitumen Membranes - Warm Roof



Building together

DANOSA UK Limited

Tel: 0845 074 0553 | www.danosa.co.uk | uktechnical@danosa.com