

Drawing Notes:

All substrates should be primed or prepared in accordance with the project specification. Structural substrates shown in this drawing are for illustrative purposes only.

All reinforced bitumen membrane side overlaps should be a minimum of 80mm and head laps a minimum of 100mm.

Note A:
Where a full bond to the substrate is required, or where ESTERDAN 30 P ELAST SEMIADHESVIO is used as the underlay, GLASDAN 800 PERFORADO does not form part of the system.

Note B:
Trim to be mechanically fastened at 200mm centres. Various profiles, colours and finishes are available. Profile shown for illustrative purposes only.

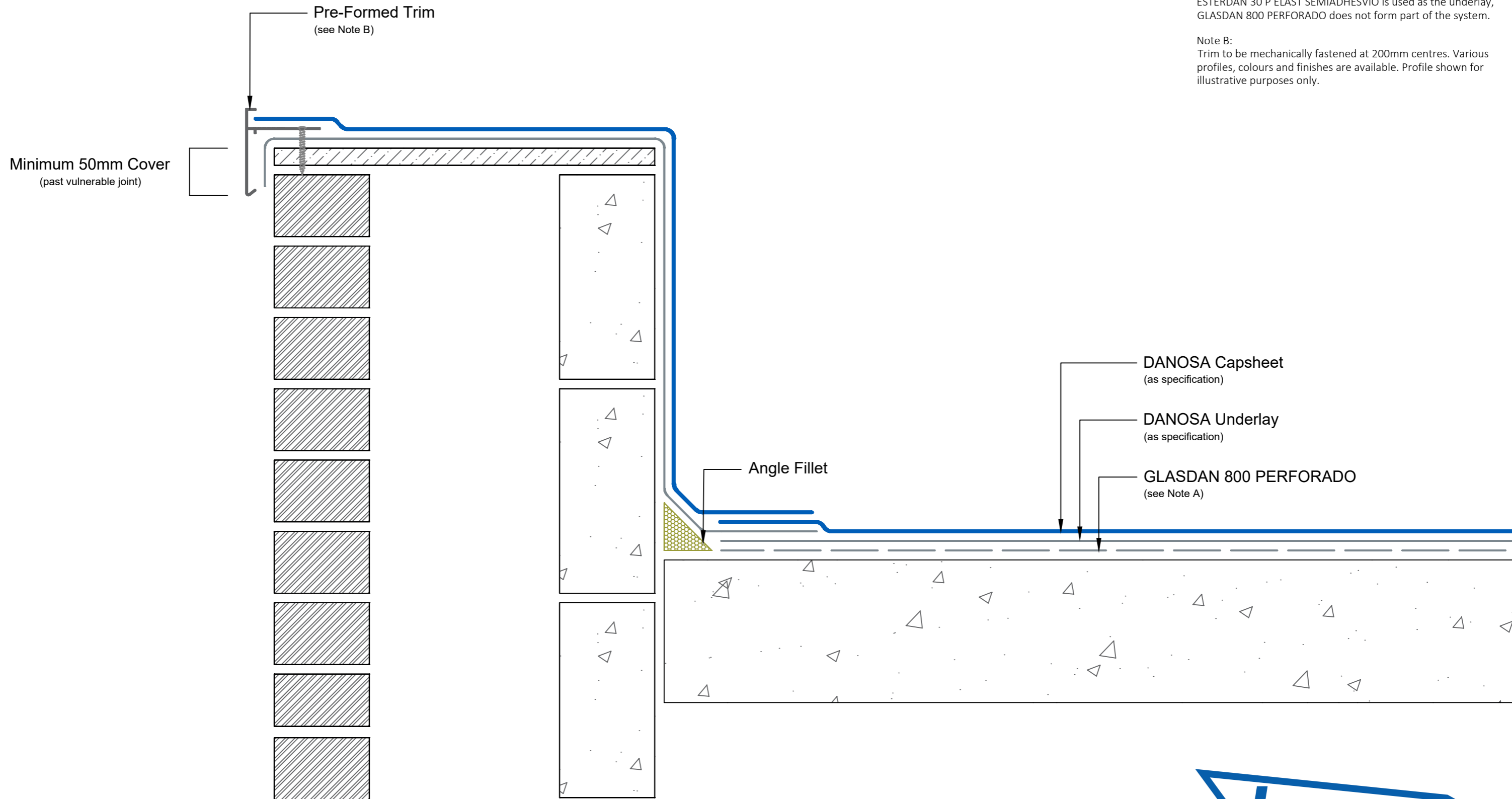

| | |
|--|------------------------|
| Drawing Number: DUK-B-(G)-242C | Revision: 01 |
| Date Drawn: February 2019 | Author: SL |

Drawing Title:
Parapet Kerb with Pre-Formed Trim
Reinforced Bitumen Membranes - Cold Roof



Building together

DANOSA UK Limited

Tel: 0845 074 0553 | www.danosa.co.uk | uktechnical@danosa.com