

Drawing Notes:

All substrates should be primed or prepared in accordance with the project specification. Structural substrates shown in this drawing are for illustrative purposes only.

Note A:
Where a full bond to the substrate is required, or where ESTERDAN 30 P ELAST SEMIADHESVIO is used as the underlay, GLASDAN 800 PERFORADO does not form part of the system.

Note B:
The selected insulation should be suitable to withstand the anticipated live and dead loadings. Compressive strength and compressive creep information is available on product Technical Datasheets.

Note C:
Timber bearers should be laid so that they do not inhibit free drainage of the roof system. If this cannot be avoided, then the bearers must sit on suitable support pads to allow free drainage underneath.

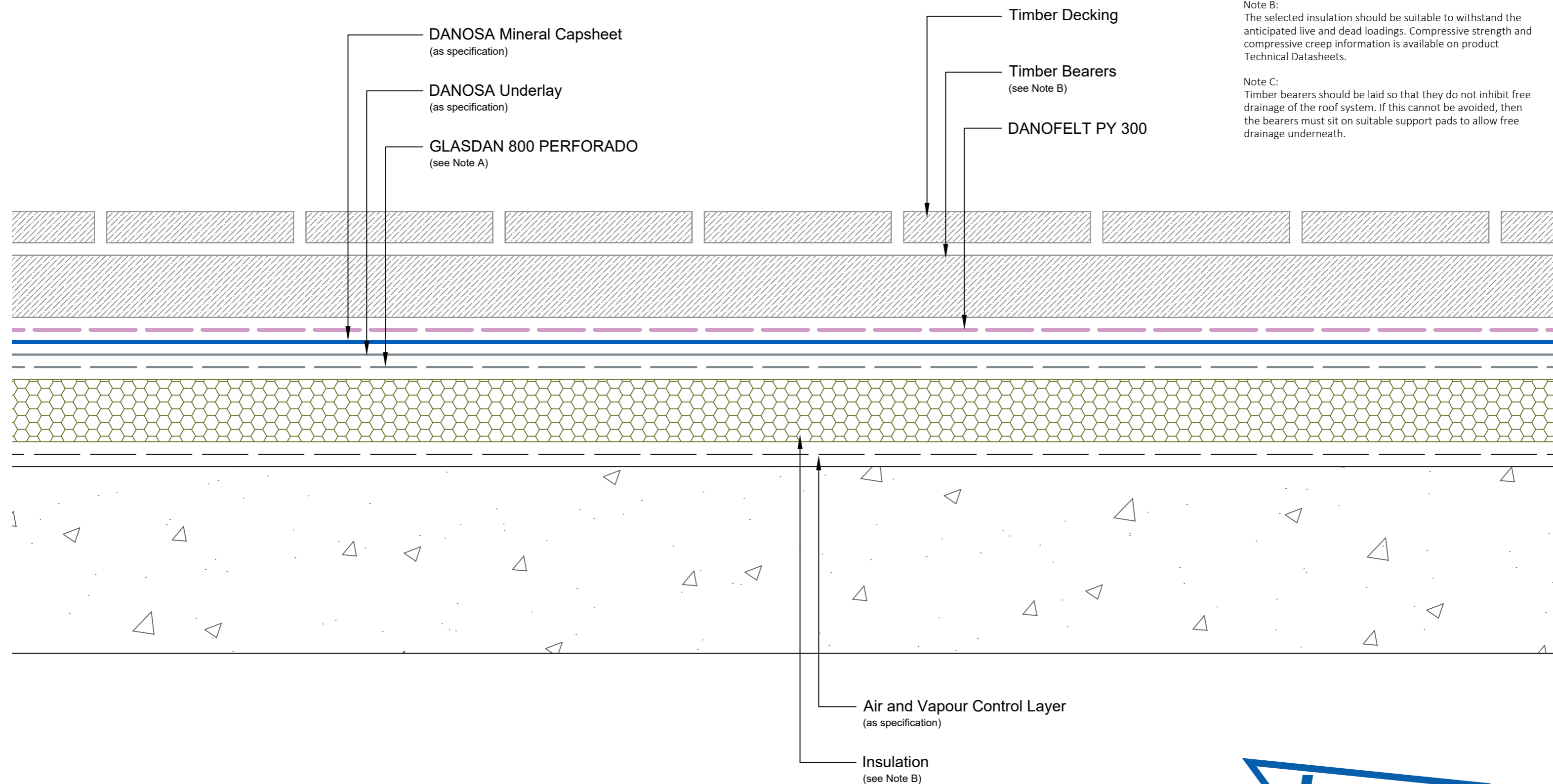

Drawing Number: DUK-B-(G)-203W	Revision: 01
Date Drawn: February 2019	Author: SL

Drawing Title:
Typical Cross Section with Timber Decking
Reinforced Bitumen Membranes - Warm Roof



Building together

DANOSA UK Limited

Tel: 0845 074 0553 | www.danosa.co.uk | uktechnical@danosa.com