

**Drawing Notes:**

All substrates should be primed or prepared in accordance with the project specification. Structural substrates shown in this drawing are for illustrative purposes only.

**Note A:**

Where a full bond to the substrate is required, or where ESTERDAN 30 P ELAST SEMIADHESVIO is used as the underlay, GLASDAN 800 PERFORADO does not form part of the system.

**Note B:**

Timber bearers should be laid so that they do not inhibit free drainage of the roof system. If this cannot be avoided, then the bearers must sit on suitable support pads to allow free drainage underneath.

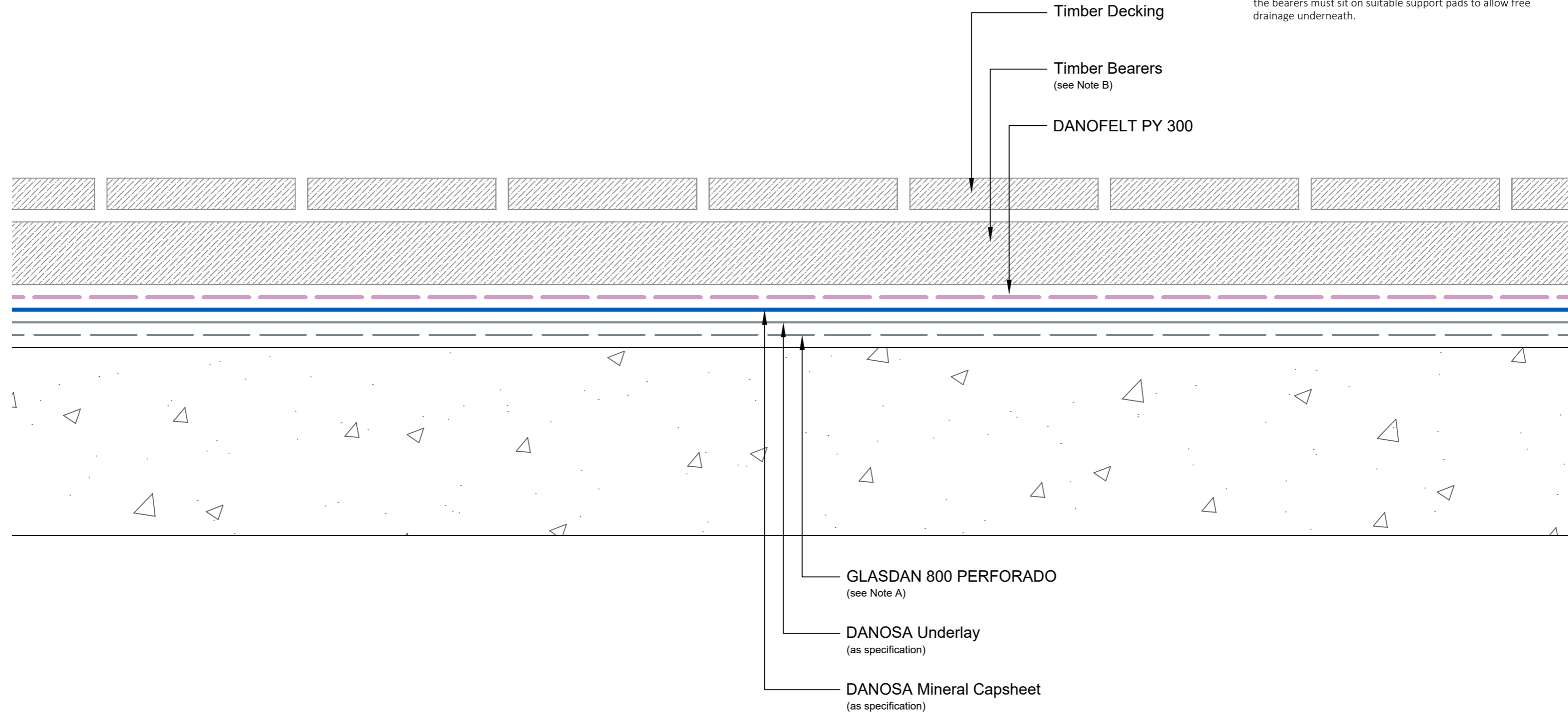

<b>Drawing Number:</b> DUK-B-(G)-203C	<b>Revision:</b> 01
<b>Date Drawn:</b> February 2019	<b>Author:</b> SL

**Drawing Title:**  
Typical Cross Section with Timber Decking  
Reinforced Bitumen Membranes - Cold Roof



**Building together**

**DANOSA UK Limited**

Tel: 0845 074 0553 | [www.danosa.co.uk](http://www.danosa.co.uk) | [uktechnical@danosa.com](mailto:uktechnical@danosa.com)