

Drawing Notes:

All substrates should be primed or prepared in accordance with the project specification. Structural substrates shown in this drawing are for illustrative purposes only.

Note A:

Where a full bond to the substrate is required, or where ESTERDAN 30 P ELAST SEMIADHESVIO is used as the underlay, GLASDAN 800 PERFORADO does not form part of the system.

Note B:

Stone ballast should be a minimum of 50mm depth. Stones should be round, 20-40mm in diameter and include no sharps.

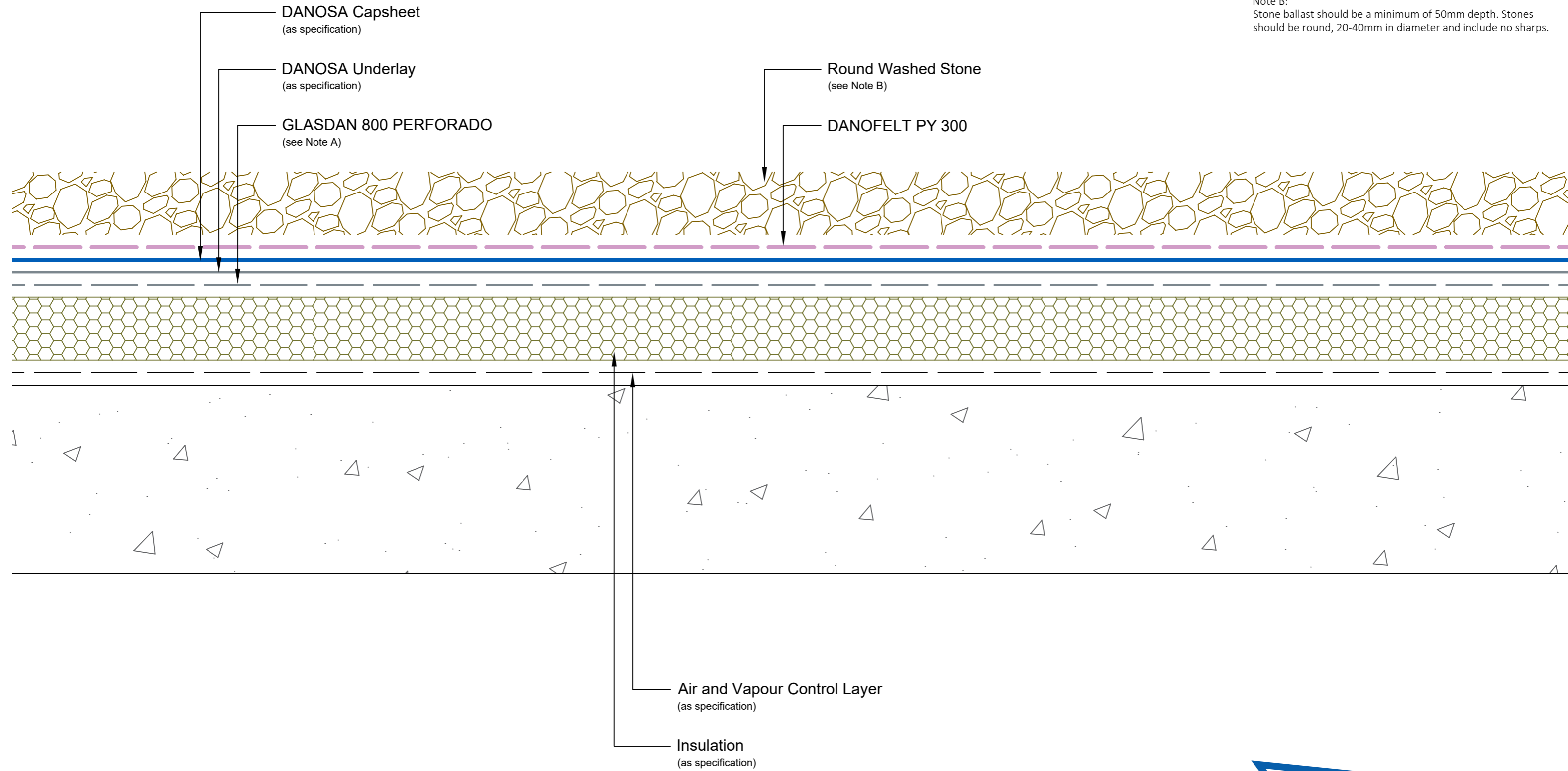

Drawing Number: DUK-B-(G)-201W	Revision: 01
Date Drawn: February 2019	Author: SL

Drawing Title:
Typical Cross Section with Stone Ballast
Reinforced Bitumen Membranes - Warm Roof



Building together

DANOSA UK Limited

Tel: 0845 074 0553 | www.danosa.co.uk | uktechnical@danosa.com