

**Drawing Notes:**

All substrates should be primed with BITUMEN PRIMER HM. Structural substrates shown in this drawing are for illustrative purposes only.

Note A:

Stone ballast should be a minimum of 50mm depth. Stones should be round, 20-40mm in diameter and include no sharps.

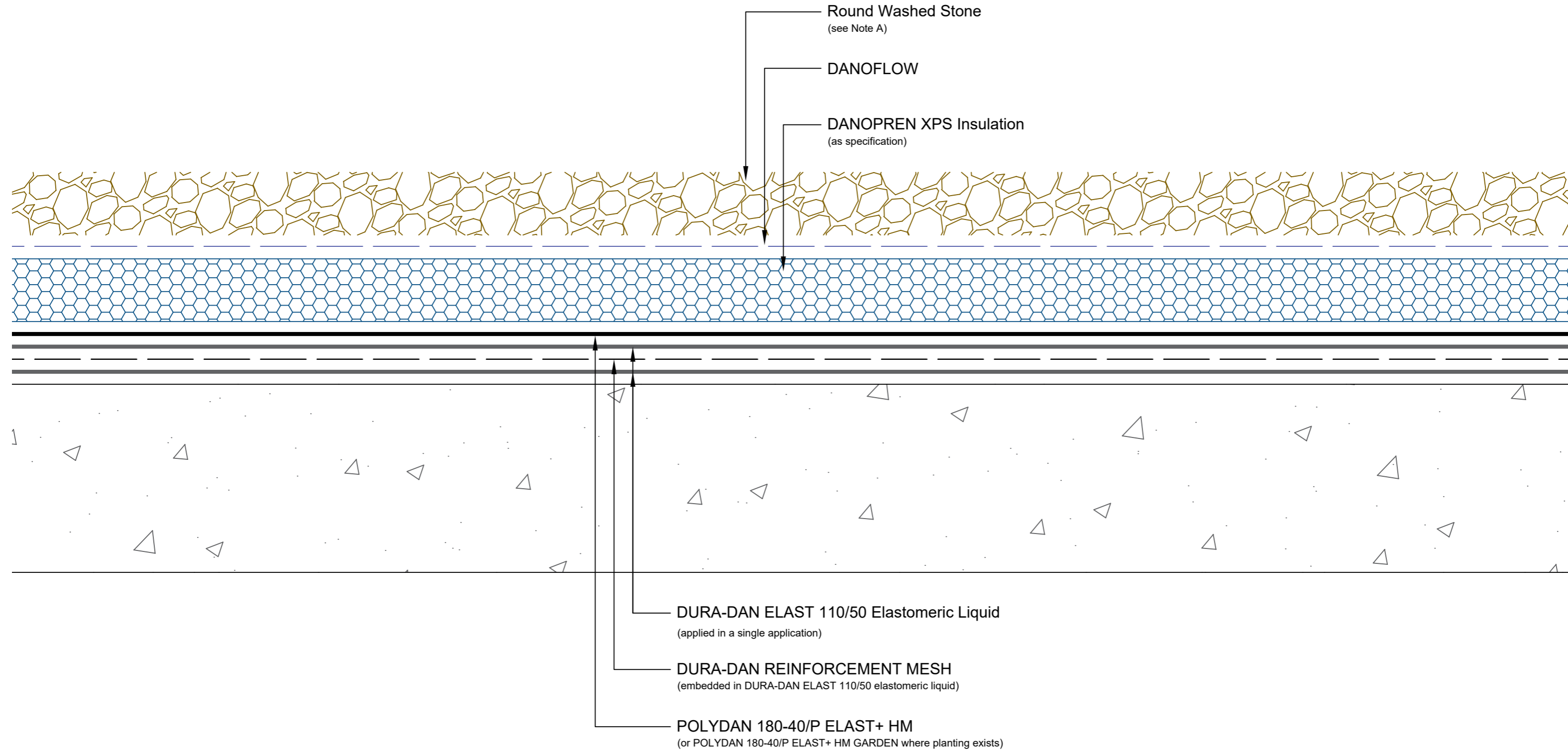

<b>Drawing Number:</b> DUK-D-(G)-201N	<b>Revision:</b> 00
<b>Date Drawn:</b> January 2019	<b>Author:</b> SL

**Drawing Title:**  
Typical Cross Section with Stone Ballast  
DURA-DAN® Structural Hot Melt - Inverted



**Building together**

**DANOSA UK Limited**

Tel: 0845 074 0553 | www.danosa.co.uk | uktechnical@danosa.com