

Drawing Notes:

All substrates should be primed with BITUMEN PRIMER HM. Structural substrates shown in this drawing are for illustrative purposes only.

Coverings have been removed for illustrative purposes only. DURA-DAN® systems must always be protected from UV radiation.

All POLYDAN and ESTERDAN membrane side overlaps should be a minimum of 80mm and head laps a minimum of 100mm.

Note A:
ProEXP expansion joints are available as ProEXP 20 (max ±20mm) or ProEXP 40 (max ±40mm) as standard.

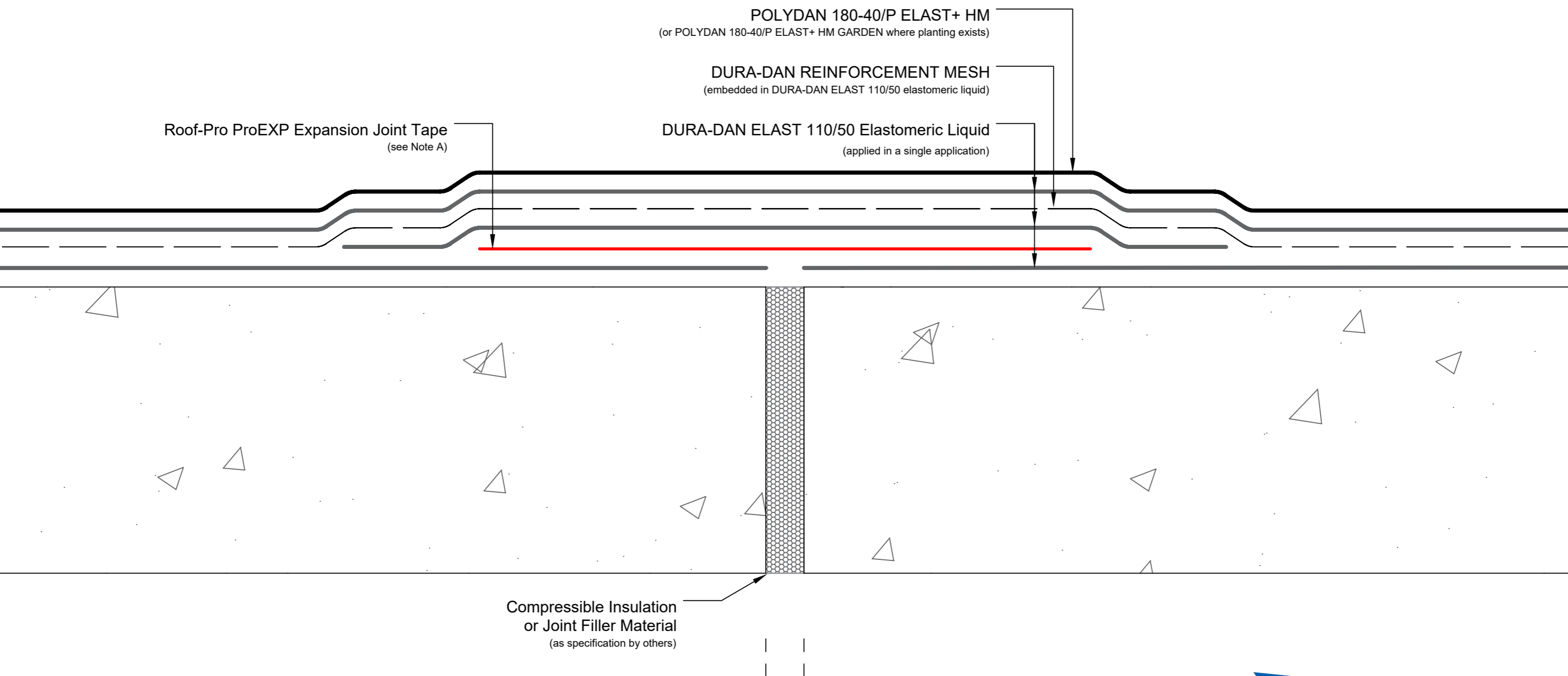

Consult ProEXP Datasheets for Maximum Expansion Details

Drawing Number: DUK-D-(G)-097	Revision: 00
Date Drawn: January 2019	Author: SL

Drawing Title:
Roof-Pro Expansion Joint
DURA-DAN® Structural Hot Melt



Building together

DANOSA UK Limited

Tel: 0845 074 0553 | www.danosa.co.uk | uktechnical@danosa.com