

Drawing Notes:

Structural substrates shown in this drawing are for illustrative purposes only.

All DANOPOL membrane hot-air welds should be between 30-40mm. Overlaps should provide sufficient cover to accommodate this requirement.

Note A:

Edge restraint bar should be mechanically fastened at 200mm centres.

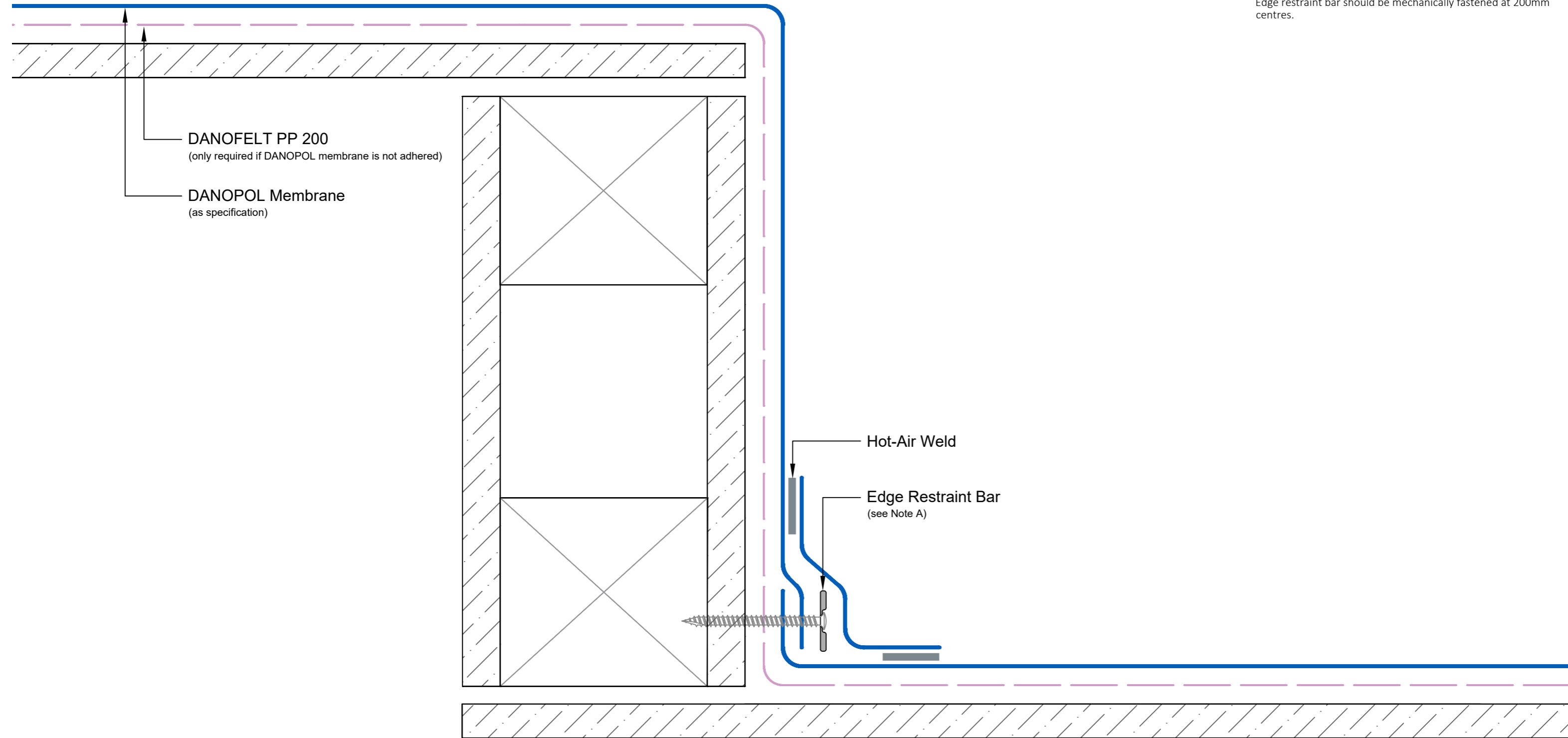

Drawing Number: DUK-S-(G)-232C	Revision: 00
Date Drawn: March 2017	Author: SL

Drawing Title:
Step In Level
DANOPOL® Single Ply Membranes - Cold Roof



Building together

DANOSA UK Limited

Tel: 0845 074 0553 | www.danosa.co.uk | uktechnical@danosa.com