

**Drawing Notes:**

Structural substrates shown in this drawing are for illustrative purposes only.

**Note A:**

Stone ballast should be a minimum of 50mm depth. Stones should be round, 20-40mm in diameter and include no sharps.

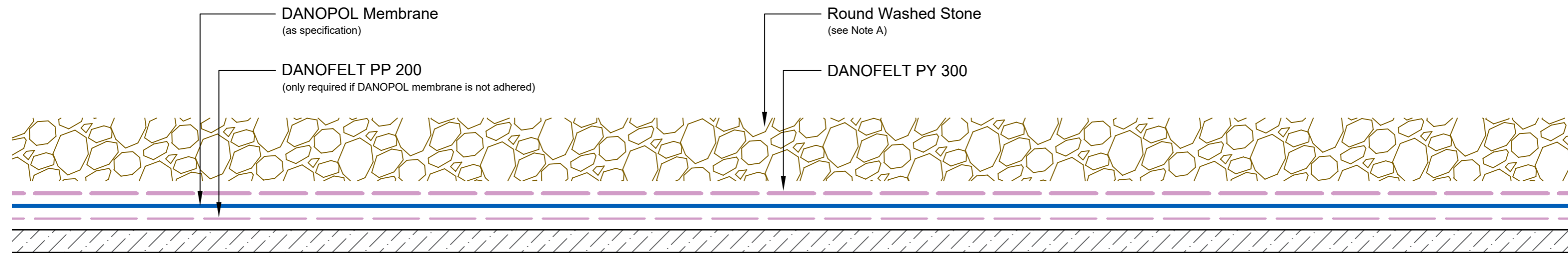

<b>Drawing Number:</b> DUK-S-(G)-201C	<b>Revision:</b> 00
<b>Date Drawn:</b> March 2017	<b>Author:</b> SL

**Drawing Title:**  
Typical Cross Section with Stone Ballast  
DANOPOL® Single Ply Membranes - Cold Roof



**Building together**

**DANOSA UK Limited**

Tel: 0845 074 0553 | [www.danosa.co.uk](http://www.danosa.co.uk) | [uktechnical@danosa.com](mailto:uktechnical@danosa.com)